



# AMELIA ISLAND BEACH PARKS

PRELIMINARY CONCEPTUAL PLANS

JULY 19, 2022



## BEACH PARK HARMONIZATION

All beach parks currently serve local residents and visitors with a variety of programming and beach access.

The harmonization effort is to create a cohesive group of beach parks for infrastructural and aesthetic purposes. The infrastructure at all beach parks - structures, facilities, wayfinding, pedestrian comfort facilities, etc - are outdated and/or missing from both the City of Fernandina Beach and Nassau County beach parks.

The aesthetics of the parks are not aligned to serve all residents equally; while one park might have a suite of facilities, another might have none. While one park might have security features, another might be lacking security features.

While there are overall design aspects to consider at all parks, each park has a concept plan outlined for a full build-out within the next decade. The hope is to harmonize the suite of services offered to local residents and visitors.



### PARK AMENITIES

- No reduction to existing program
- More passive uses & increased space for small gatherings
- Increased bicycle amenities
- Expand utility & storage
- Additional guard stations for security where needed



### AESTHETIC COHESION

- All parks to have **one** established style:
  - Wayfinding/signage
  - Architectural character
  - Hardscape typologies
  - Site furnishings



### PARKING

- Maintain existing parking spaces as applicable
- Prioritize permeable pavers for surface parking to reduce heat and increase stormwater capture
- Shade at parking should be prioritized; natural (tree) or solar shade structures if applicable to space



### ENVIRONMENTAL PROTECTION

- Dune Protection
- Prioritize Native Planting
- Harmonize Ecological Education Opportunities

## PROJECT TIMELINE

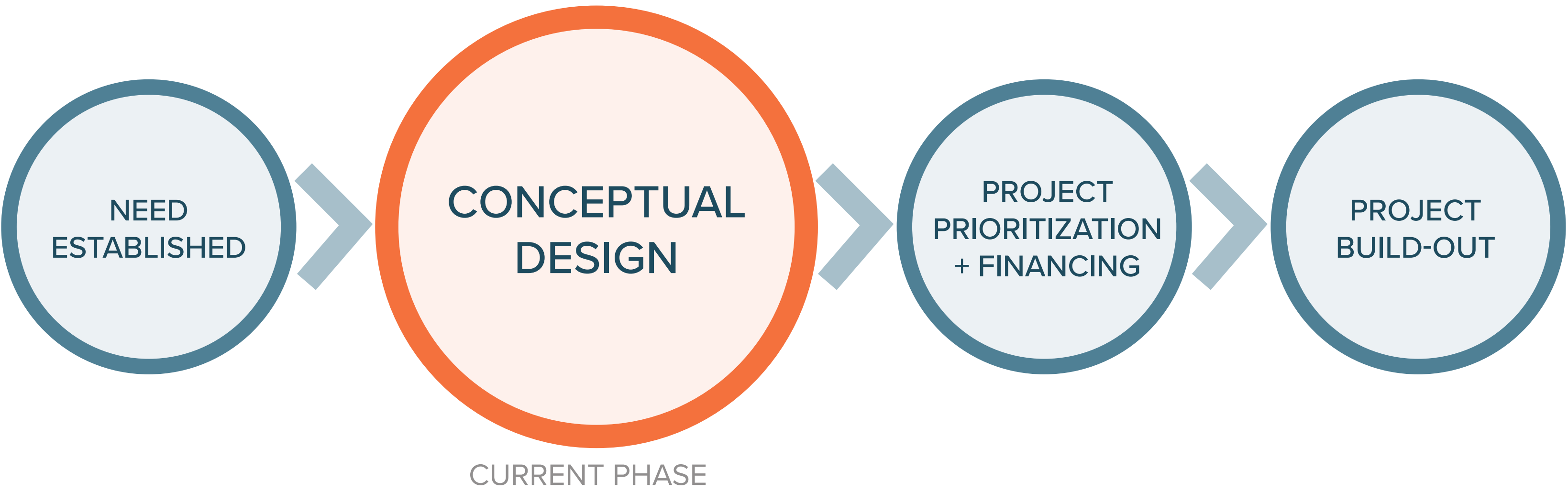



BY THE NUMBERS...

- 1000+ RESPONSES
- 90%

RESPONDENTS USE THE BEACH PARKS YEAR-ROUND
- 86%

RESPONDENTS LIVE WITHIN THE 32034 AREA CODE
- 75%

RESPONDENTS USE THE PARKS ON WEEKENDS VS WEEKDAYS
- 73%

RESPONDENTS ARE BETWEEN THE AGES OF 51-65+
- 60%

RESPONDENTS PROVIDED FEEDBACK ON MORE THAN ONE BEACH PARK
- 29%

RESPONDENTS HAVE NO COMPLAINTS WITH CURRENT BEACH PARKS
- 26%

RESPONDENTS THINK THE PARKS ARE OVERCROWDED

- WISH LIST
- 1

REMAIN AS THEY ARE
- 2

DECREASE LITTER
- 3

MORE NATURE, LESS DEVELOPMENT
- 4

MORE PARKING
- 5

INCREASE SHADE CANOPY

MOST ENJOYED PARK

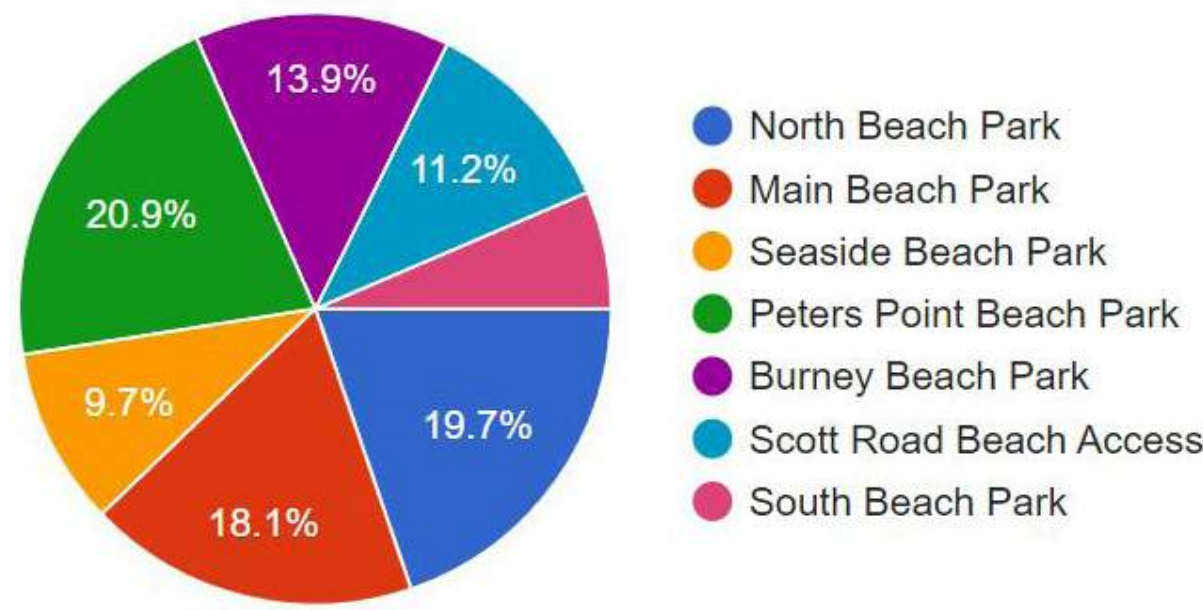

RESPONDENTS HOME ZIP CODE

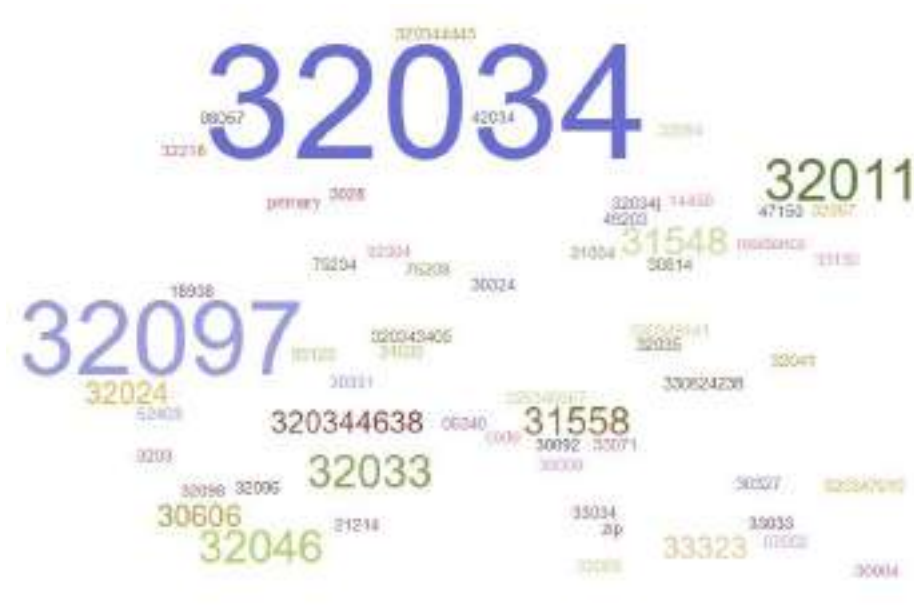

MAJOR TAKEAWAYS...

- WHAT'S MISSING:

WASTE RECEPTACLES, RESTROOMS, & PARKING
- ACCESS:

OVER HALF OF RESPONDENTS WALK TO ACCESS THE BEACH PARKS
- PUBLIC ACCESS:

OVER HALF OF RESPONDENTS WOULD **NOT** USE PUBLIC TRANSPORTATION, IF AVAILABLE
- MOST POPULAR BEACH PARK:

MAIN BEACH AND PETERS POINT BEACH PARK
- MOST POPULAR ACTIVITY:

ACCESS BEACH (BEACH ACTIVITIES), ENJOY NATURE
- COMMON COMMENTS:

MOST RESPONDENTS WOULD LIKE TO SEE EXISTING INFRASTRUCTURE UPGRADED & MORE AMENITIES AT KEY PARKS TO ENHANCE PASSIVE RECREATION AND PEDESTRIAN COMFORT COMPONENTS

PETERS POINT BEACH PARK

- 1

43% of respondents visit weekly; 33% monthly
- 2

87% access by car; 17% walk; 14% bike
- Most respondents like that Peters Point
- 3

has on-beach parking access and the proximity to nearby homes.
- 4

Most respondents are concerned at how busy the on-beach parking is and the overall noisiness.
- 5

On-beach parking and horseback riding are the most noted activities.
- 6

Children's play area, increased landscaping, more seating, and updated facilities are desired.

SCOTT ROAD BEACH ACCESS

- 1

50% of respondents visit weekly; 22% daily
- 2

76% access by car; 38% walk; 23% bike
- Most respondents like the proximity to nearby homes & the natural state (compared to other beach parks)
- 3

Most respondents would like restrooms and the (on-beach driving) vehicle traffic
- 4

The majority of respondents would like to see
- 5

Scott Road stay the same as is, but some would also like to add a restroom

BURNEY BEACH PARK

- 1

53% of respondents visit weekly; 21% monthly
- 2

77% access by car; 31% walk; 22% bike
- Most respondents like that Burney
- 3

Beach Park is quiet, less crowded, & has updated facilities.
- 4

Most respondents like how the park is currently (no dislikes) or dislike how close the on-beach parking is to the beach park.
- Most respondents noted liking the general beach
- 5

day activities for defining Burney Beach Park: swimming in, sunbathing, fishing, gatherings, shelling, walking the beach, etc..
- 6

Many respondents like the existing park, but quite a few would like to see fewer cars (on the beach) and increased surveillance.

NORTH BEACH PARK

- 1

50% of respondents visit weekly
- 2

75% access by car; 24% walk
- Most respondents like that North Beach
- 3

Park is less crowded and quieter than the other beach parks
- 4

Most respondents want restrooms
- 5

Passive activities are the preferred use

MAIN BEACH PARK

- 1

56% of respondents visit weekly
- 2

83% access by car; 26% walk
- Most respondents like the amenities and facilities
- 3

(restrooms) that are offered at Main Beach Park
- Most respondents think Main Beach is
- 4

(1) overcrowded (not enough parking) & (2) does not have enough facilities for the amount of users (waste receptacles, outdated infrastructure)
- 5

The playground is well used, even if outdated

SEASIDE BEACH PARK

- 1

47% of respondents visit weekly
- 2

65% access by car; 34% walk
- Most respondents like Seaside for its
- 3

location and access to adjacent amenities
- 4

Most respondents want more parking
- 5

Beach parking & on-beach driving define this park the most

SOUTH BEACH ACCESS

- 1

34% of respondents visit monthly; 29% weekly; 20% daily
- 2

72% access by car; 11% bike
- Most respondents like the peace and quiet
- 3

of the natural setting.
- Most respondents noted liking the general beach
- 4

day activities: swimming in, sunbathing, fishing, gatherings, shelling, walking the beach, etc..
- 5

The majority of respondents would like to see South Beach Access stay the same as is, but some would also like to add restrooms and more waste receptacles



Establishing a set of targeted amenities to provide pedestrian comfort to all parks equally will bring harmonization and cohesion to the Amelia Island Beach Parks.



ACCESSIBILITY

- Site Access (Direct)
- Accessibility (ADA)
- Public Transportation
- Public Safety



ENVIRONMENTAL  
PRESERVATION +  
EDUCATION

- Dune Protection
- Celebration of Native Environment
- Environmental Education



SITE FURNISHING  
FAMILIES

- Site Furnishings Include:
- Seating
  - Rinse Stations
  - Lighting
  - Shade Structures
  - Waste Receptacles
  - Restrooms
  - WiFi (Smart Technology)



PASSIVE  
AND ACTIVE  
RECREATION

- Passive Recreation Can Include:
- Bird Watching
  - Walking/Hiking
  - Picnicking
  - Photography
  - Nature Trail
  - Outdoor Classroom/ Nature Study
  - Garden
  - Area to Relax
- Active Recreation Can Include:
- Sports Field
  - Sports Court
  - Outdoor Gym Equipment
  - Skateboard Park
  - Bike Trail
  - Space for Aerobics



SITE  
CHARACTER

- Wayfinding
- Environmental Branding
- Beach Park Harmonization
- Special Characteristics



# NORTH BEACH PARK | PRELIMINARY CONCEPT

## DESIGN FOCUS

**ACCESS**  
Connection in NW corner for community and (potentially, long-term) to Fort Clinch

**INCREASED PROGRAM**  
Additional pavilions and expanded boardwalk to accommodate usage; increase wash stations (●)

**SIGNAGE + WAYFINDING**  
Entry signage ( / ), functional signage ( ● ), educational signage ( ■ ), & water life safety demarcation ( ▲ ), as needed

## LEGEND

- 1 Boardwalk (ADA Accessible)
- 2 Protected Dunescape
- 3 Parking
- 4 Pavilion
- 5 Increased Native Landscape
- 6 Restrooms / Wash Stations
- 7 Utility Structure

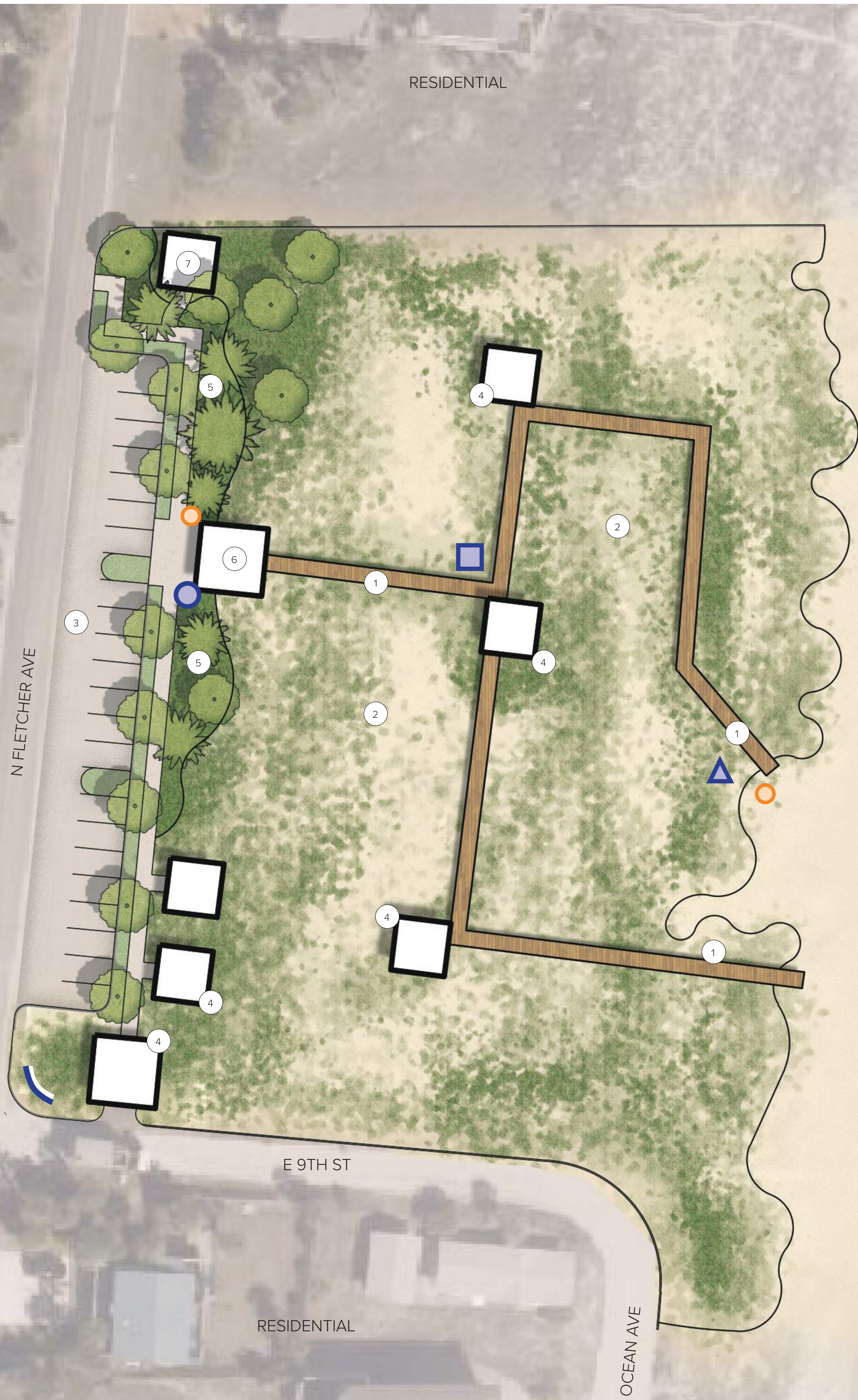



# MAIN BEACH PARK | PRELIMINARY CONCEPT - OPTION A

## DESIGN FOCUS

- ACCESS**  
Elevate great lawn: create formal pedestrian pathway
- ACTIVE PROGRAM**  
Redesign and expansion of skate park; playground; addition of dog park; clustering of program
- PASSIVE PROGRAM**  
Maintain existing boardwalk system; festival street; increase in small group pavilions; additional multi-use plazas; increase wash stations (●)
- PARKING**  
Realignment of parking to better suit increased program
- SIGNAGE + WAYFINDING**  
Entry signage ( / ), functional signage ( ● ), educational signage ( ■ ), & water life safety demarcation ( ▲ ), as needed

## LEGEND

- 1 Boardwalk (ADA Accessible)

2 Protected Dunescape

3 Parking (Surface Lot, Parallel, Parking)
- 4 Pavilion

5 Vehicular Festival Street

6 Restrooms / Wash stations
- 7 Usable, Open Space

8 Play Space

9 Skate park
- 10 Vehicular Drop-Off

11 Pedestrian Pathway

12 Multi Use Hardscape Plaza (Permeable)
- 13 Multi Use Courts

14 Putt Putt

15 Utility Structure
- 17 Gateway Art



PERMEABLE PAVERS



PAVILIONS



DOG PARK





# MAIN BEACH PARK | PRELIMINARY CONCEPT - OPTION B

## DESIGN FOCUS

- ACCESS**  
Elevate great lawn: create performance space
- ACTIVE PROGRAM**  
Redesign and expansion of skate park; playground; clustering of program; addition of dog park
- PASSIVE PROGRAM**  
Connection of dune boardwalks; multi-use plazas + festival street; increase in small group pavilions; addition of multi-use plazas; increase wash stations (🟡)
- PARKING**  
Realignment of parking; potential for future parking garage
- SIGNAGE + WAYFINDING**  
Entry signage ( / ), functional signage ( 🔵 ), educational signage ( 🔵 ), & water life safety demarcation ( 🔴 ), as needed

## LEGEND

- |                              |                             |   |
|------------------------------|-----------------------------|---|
| 1 Boardwalk (ADA Accessible) | 2 Protected Dunescape       | 3 Parking (Surface Lot, Parallel, Parking Garage) |
| 4 Pavilion                   | 5 Vehicular Festival Street | 6 Restrooms / Wash stations                       |
| 7 Usable, Open Space         | 8 Play Space                | 9 Skate park                                      |
| 10 Formal Amphitheater       | 11 Pedestrian Pathway       | 12 Multi Use Hardscape Plaza (Permeable)          |
| 13 Multi Use Courts          | 14 Putt Putt                | 15 Utility Structure                              |





# MAIN BEACH PARK | PREFERRED RELIMINARY CONCEPT - OPTION C

## DESIGN FOCUS

**ACCESS**  
Elevate great lawn; create formal pedestrian pathway; addition of informal performance space

**ACTIVE PROGRAM**  
Redesign and expansion of skate park; playground; addition of dog park; clustering of program

**PASSIVE PROGRAM**  
Enhance+connect existing boardwalk system; create festival street; increase in small group pavilions; additional multi-use plazas; increase wash stations (🚿)

**PARKING**  
Slight realignment of parking

**SIGNAGE + WAYFINDING**  
Entry signage ( / ), functional signage ( 🚿 ), educational signage ( 📖 ), & water life safety demarcation ( ⚠️ ), as needed

## LEGEND

- |                                 |                             |   |
|---------------------------------|-----------------------------|---|
| 1 Boardwalk (ADA Accessible)    | 2 Protected Dunescape       | 3 Parking (Surface Lot, Parallel Parking) |
| 4 Pavilion                      | 5 Vehicular Festival Street | 6 Restrooms / Wash stations               |
| 7 Usable, Open Space            | 8 Play Space                | 9 Skate park                              |
| 10 Informal, Grass Amphitheater | 11 Pedestrian Pathway       | 12 Multi Use Hardscape Plaza (Permeable)  |
| 13 Multi Use Courts             | 14 Putt Putt                | 15 Utility Structure                      |
| 16 Vehicular Drop-off           |                             |   |





# SEASIDE BEACH PARK | PRELIMINARY CONCEPT

## DESIGN FOCUS

**PROGRAM**  
Multi-use plaza (vehicular) space  
at beach driving access point;  
increase wash stations (○)

**ACCESS + PARKING**  
ROW parking along Sadler, maintain  
current parking lot along Fletcher;  
drop-off space lane within park

**SIGNAGE + WAYFINDING**  
Entry signage ( / ), functional  
signage ( ● ), educational signage  
( ■ ), & water life safety demarcation  
( ▲ ), as needed

## LEGEND

- |                                 |                                 |   |
|---------------------------------|---------------------------------|---|
| 1 Boardwalk<br>(ADA Accessible) | 2 Protected<br>Dunescape        | 3 Parking<br>(Surface Parking,<br>Parallel Parking) |
| 4 Pavilion                      | 5 Vehicular<br>Festival Street  | 6 Restrooms/<br>Wash Stations                       |
| 7 Pedestrian<br>Access          | 8 Pop-up<br>pedestrian<br>space | 9 Vehicular<br>Drop-off                             |
| 10 Guard Station                |                                 |   |

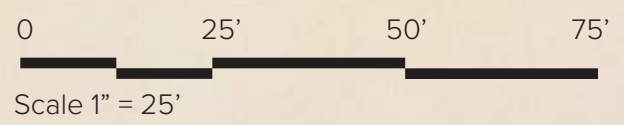
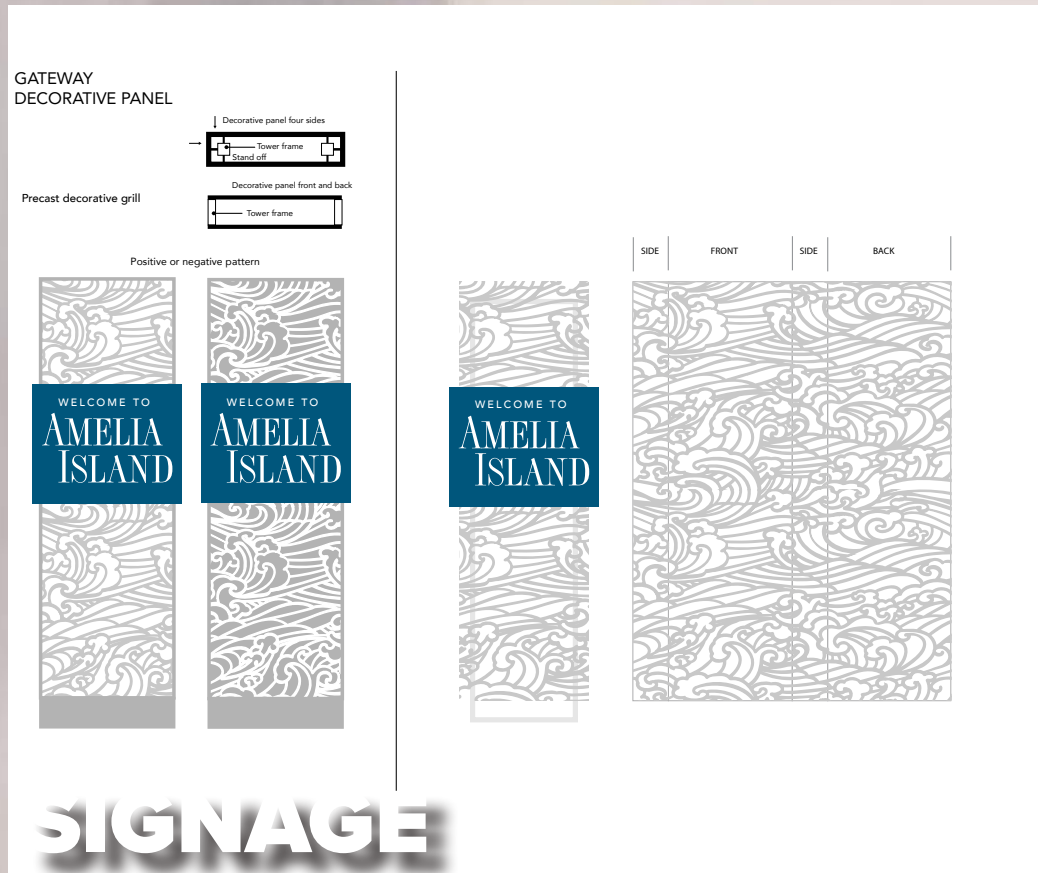



# PETERS POINT BEACH PARK | PRELIMINARY CONCEPT

## DESIGN FOCUS

**ACTIVE + PASSIVE PROGRAM**  
Designated gathering space (food trucks, larger gathering), designated space for equestrian usage; increased pavilions throughout park space; addition of dog park; increase wash stations (○)

**ADJACENT CONNECTIONS**  
Physical, bike+pedestrian connection from trail to park via multi-use trail hub

**PARKING**  
Shade parking, increased parking landscape, slight reduction in parking to prioritize program expansion

**ACCESSIBILITY**  
Prioritize one beach walkover for ADA access

**SIGNAGE + WAYFINDING**  
Entry signage ( / ), functional signage ( ○ ), educational signage ( □ ), & water life safety demarcation ( △ ), as needed

## LEGEND

- |  |                       |  |
|--|-----------------------|--|
| 1 Boardwalk (Overlook; ADA Accessible) | 2 Protected Dunescape | 3 Parking (Surface Parking)                |
| 4 Pavilion                             | 5 Trailer Parking     | 6 Large Pavilion/ Restrooms                |
| 7 Usable, Open Space                   | 8 Utility Structure   | 9 Multi-Use Trail (Bicycle+Pedestrian) Hub |
| 10 Guard Station                       | 11 Pedestrian Pathway | 12 Multi Purpose Space                     |

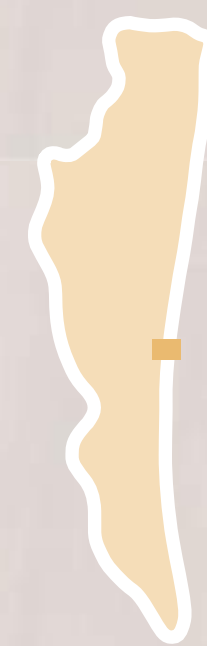
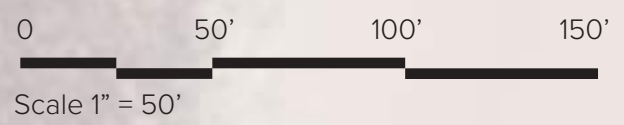



# SCOTT ROAD BEACH ACCESS | PRELIMINARY CONCEPT



## DESIGN FOCUS

**PROGRAM**  
Program with pedestrian comfort facilities, additional secondary gathering spaces; increase wash stations (○)

**PARKING**  
Slight reduction in parking to prioritize pedestrian comfort components; increased landscape within parking lot

**BEACH PARK**  
Elevate (formalize) beach access to beach park based on increased program

**SIGNAGE + WAYFINDING**  
Entry signage ( / ), functional signage ( ○ ), educational signage ( □ ), & water life safety demarcation ( ▲ ), as needed

## LEGEND

- 1 Boardwalk (ADA Accessible)
- 2 Protected Dunescape
- 3 Parking
- 4 Pavilion
- 5 Trailer Parking (Future)
- 6 Restrooms / Wash Stations
- 7 Utility Structure
- 8 Guard Station

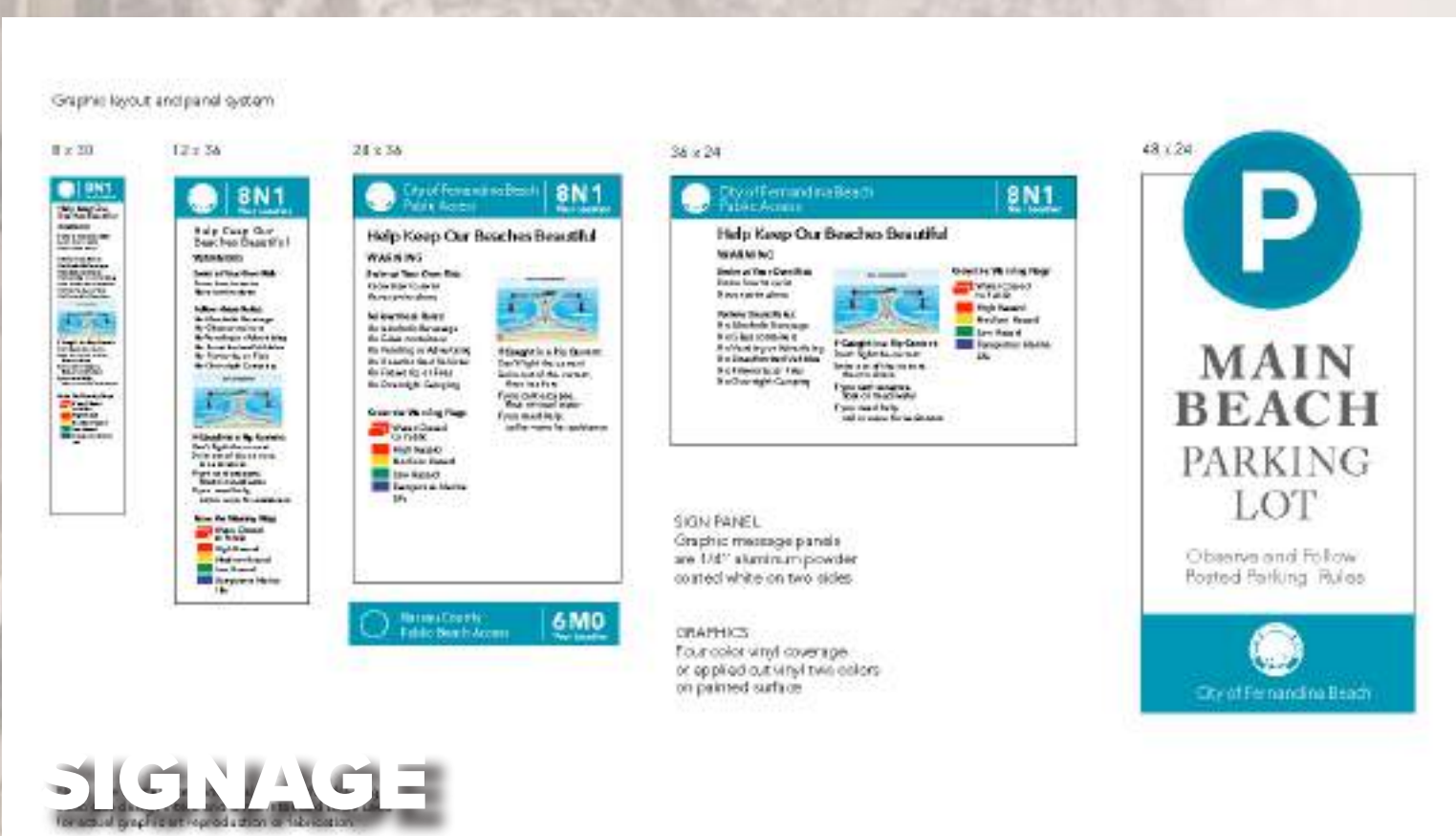



# BURNEY BEACH PARK | PRELIMINARY CONCEPT



## DESIGN FOCUS

### ADJACENT CONNECTIONS

Roundabout, pedestrian pathway to American Beach Community

### PROGRAMMING

Increase in pavilions and 'play' space (playground and/or stage {permeable/ specialty pavers} area); increase wash stations (●)

### PARKING

ROW parking along Burney Road; slight reduction in parking to prioritize pedestrian comfort; increased in shade landscape at parking

### SIGNAGE + WAYFINDING

Entry signage ( / ), functional signage ( ● ), educational signage ( ■ ), & water life safety demarcation ( ▲ ), as needed

## LEGEND

- |                              |  |   |
|------------------------------|--|---|
| 1 Boardwalk (ADA Accessible) | 2 Protected Dunescape                        | 3 Parking (Surface parking, Parallel Parking) |
| 4 Pavilion                   | 5 Vehicular Access (Reduction to One Access) | 6 Restrooms / Wash Station                    |
| 7 Usable, Open Space         | 8 Play Space                                 | 9 Vehicular Drop-Off (Permeable)              |
| 10 Pedestrian Pathway        | 11 Utility Structure                         |   |



PLAY



PAVILIONS



ADA ACCESSIBILITY

RESIDENTIAL



SHADED PARKING



PEDESTRIAN CONNECTION

ATLANTIC OCEAN

0 50' 100' 150'  
Scale 1" = 50'





# SOUTH BEACH ACCESS | PRELIMINARY CONCEPT

## DESIGN FOCUS

**PROGRAM**  
Program with pedestrian comfort facilities, additional secondary gathering spaces; increase wash stations (●)

**GATEWAY**  
Signage feature for wayfinding at entrance

**PARKING**  
Slight reduction in parking to prioritize pedestrian comfort

**BEACH PARK**  
Prioritize one beach walkover for ADA access

**SIGNAGE + WAYFINDING**  
Entry signage ( / ), functional signage ( ● ), educational signage ( ■ ), & water life safety demarcation ( ▲ ), as needed

## LEGEND

- |                              |                       |                             |
|------------------------------|-----------------------|-----------------------------|
| 1 Boardwalk (ADA Accessible) | 2 Protected Dunescape | 3 Parking (Surface Parking) |
| 4 Pavilion                   | 5 Vehicular Access    | 6 Restrooms / Wash Station  |



SIGNAGE



BOARDWALK



ADA ACCESSIBILITY



TREE CANOPY



SMART TECHNOLOGY

0 50' 100' 150'  
Scale 1" = 50'





# BEACH PARK AESTHETICS | CONCEPT ALTERNATIVES

## FORMS RESTROOMS, PAVILIONS, SHADE STRUCTURES

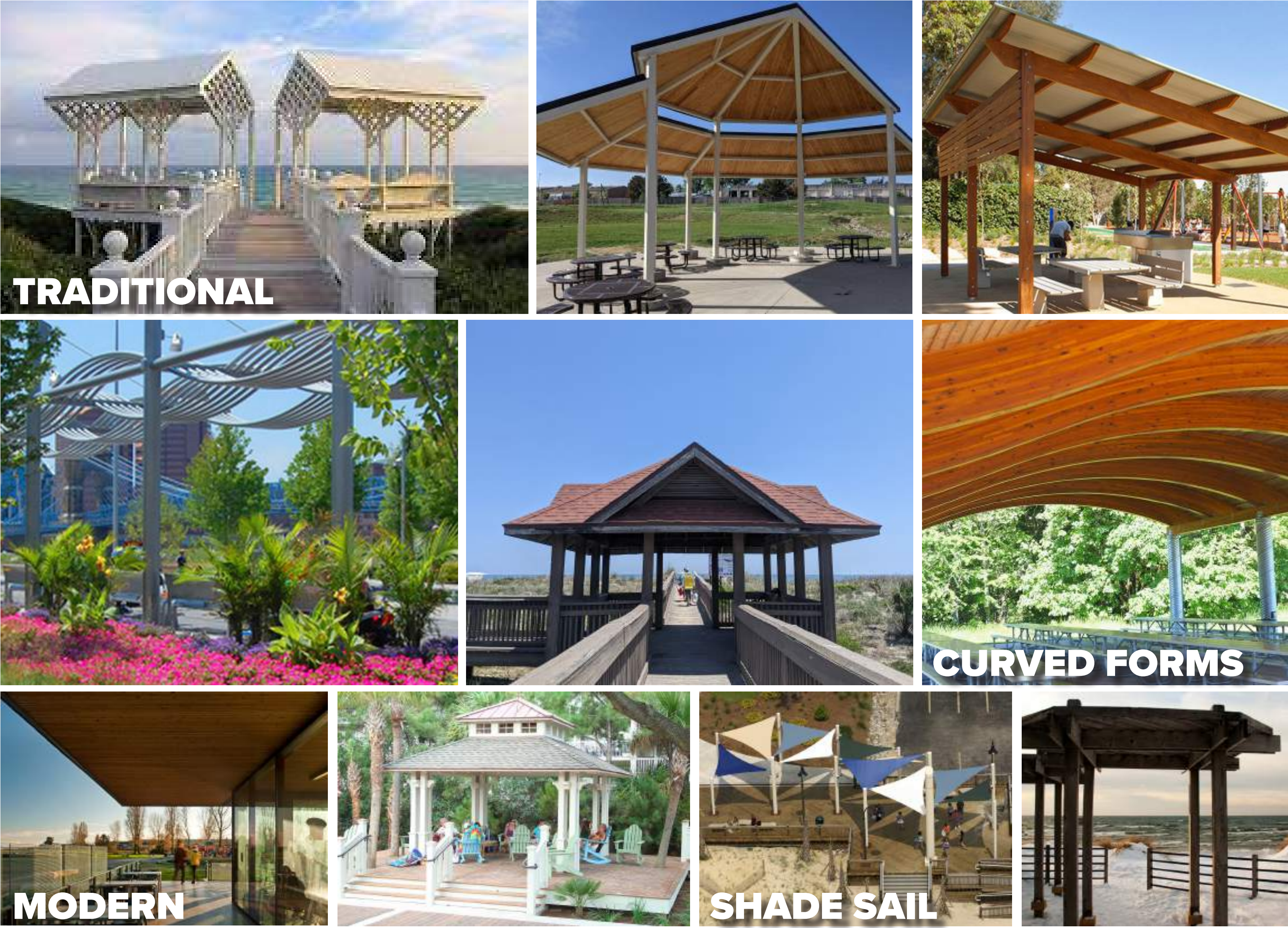

## LANDSCAPE A NATIVE LANDSCAPE PALETTE TO PROVIDE INCREASED BUFFER, SHADE, AND NATURAL BEAUTY

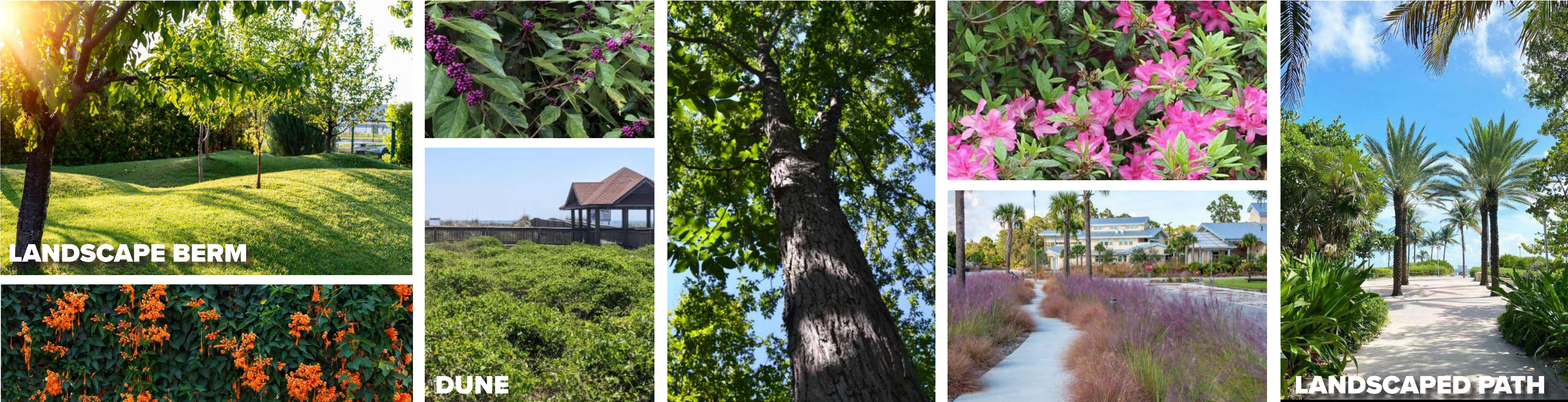

## HARDSCAPE VEHICULAR AND PEDESTRIAN TEXTURES AND PATTERNS

